

F60



LIVE THE EXTRAORDINARY

In the F60, Italian taste is present in every detail, bringing a unique and sophisticated personality to the yacht.

Quality and attention to the choice of materials are once again paramount, validating the expertise of Italian design and all the characteristics already recognized in the historic Sessa Marine brand.





Main Hall

In the main salon, large windows illuminate the welcoming living room, which provides access to a high-tech command center with all the necessary equipment for operating and monitoring the vessel.

Located on the same deck, the kitchen is connected to the outdoor area with the aft cockpit, forming a large leisure area.

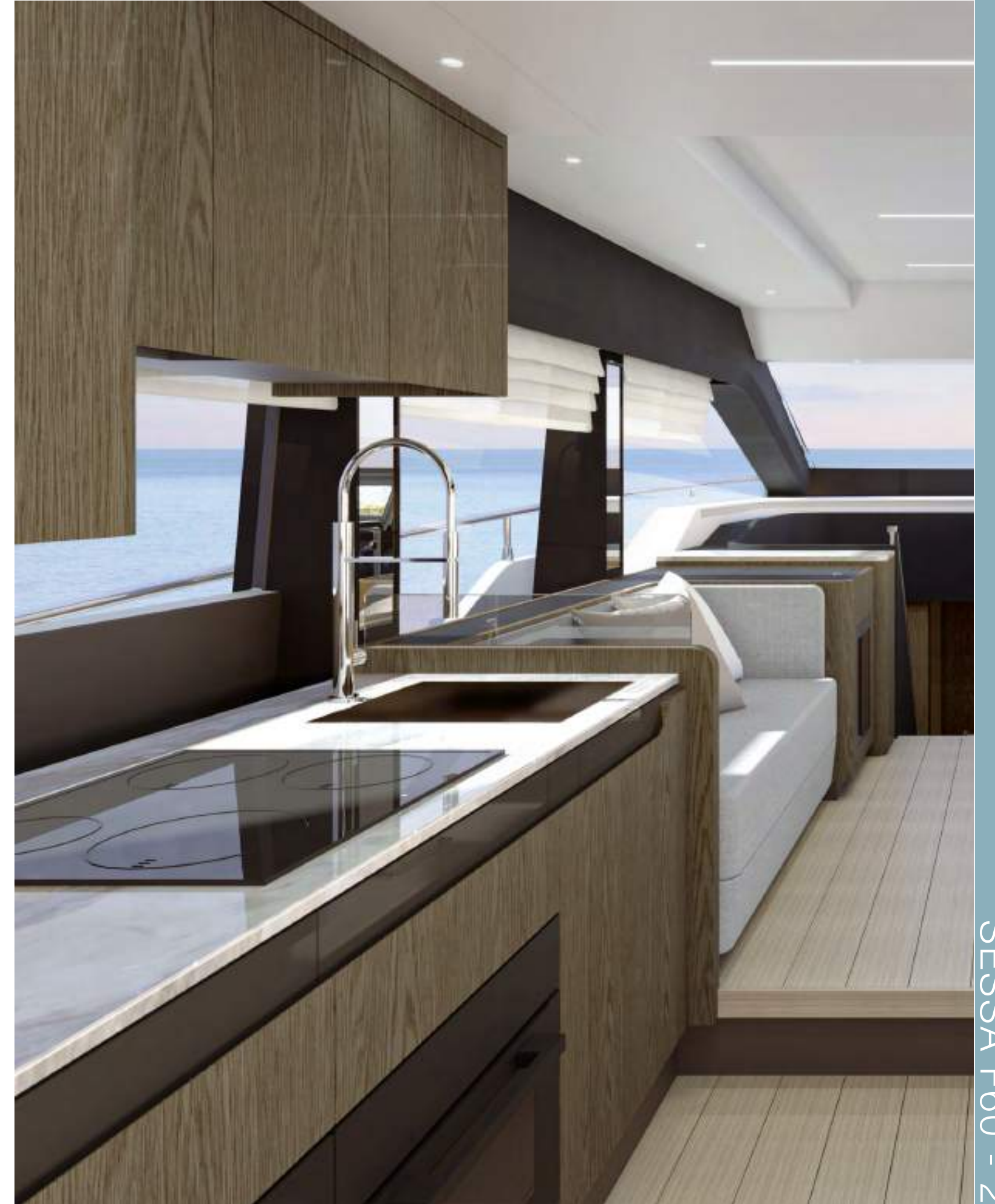

Lower Deck

In the private area on the lower deck, guests can enjoy privacy and independence in a cozy interior space that includes a support lobby and three suites.



Experiences

To further enhance the onboard experience, active home automation, audio, and connectivity systems are available, allowing for more time onboard complete with every modern convenience.

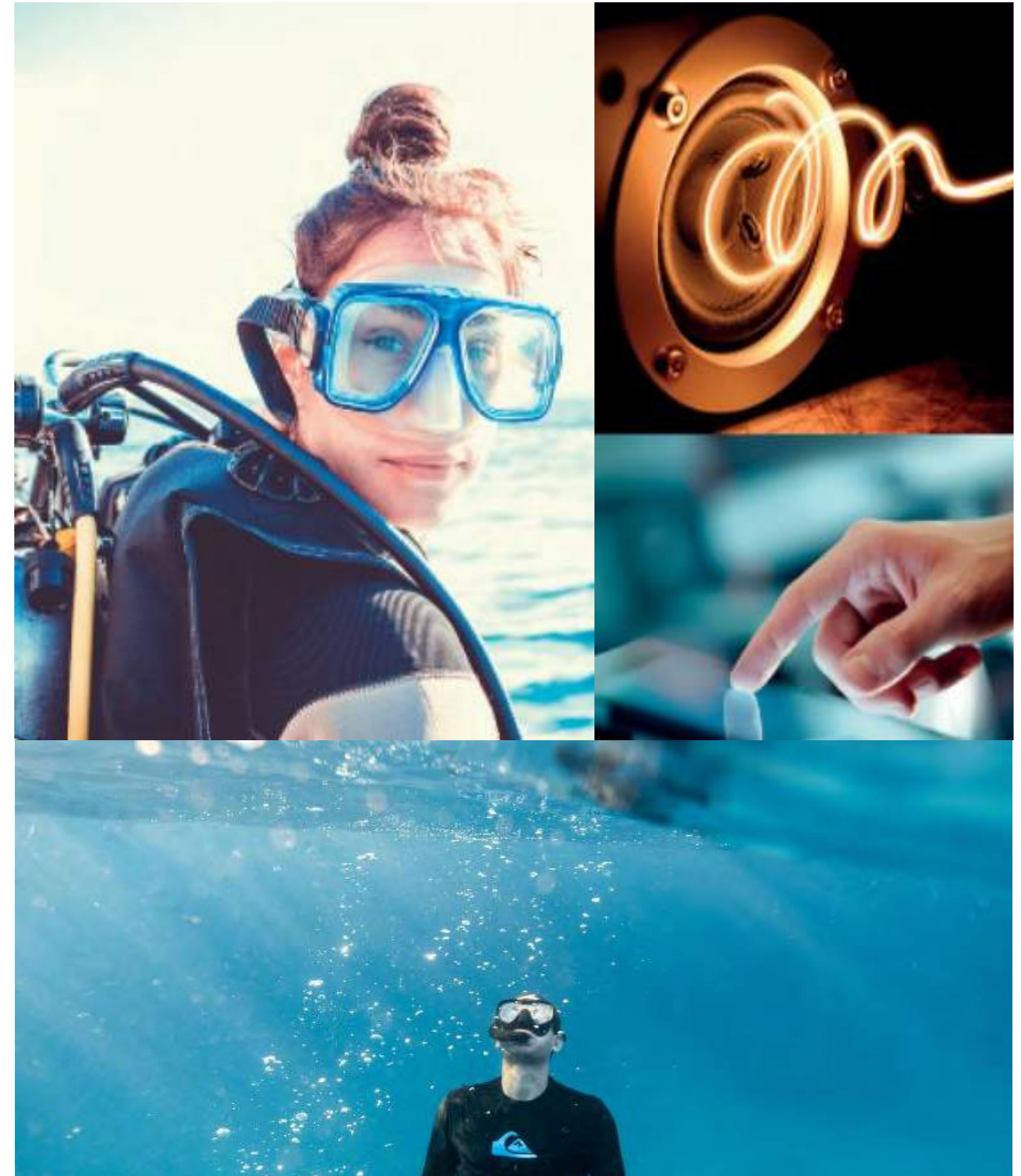

Owner's Cabin

With elegant and modern design, the owner's cabin is located midship, taking advantage of the full beam of the vessel.

Featuring a private bathroom, sofa, and walk-in closet, it offers ample space and comfort during stays.



Guest Cabin

The spacious and sophisticated VIP suite is located forward, while the third cabin, which includes a dynamic bathroom that can be shared with guests, is starboard.



Sailor Cabin

For added functionality, the yacht also includes a separate area with independent access for the crew, featuring a private cabin and bathroom.

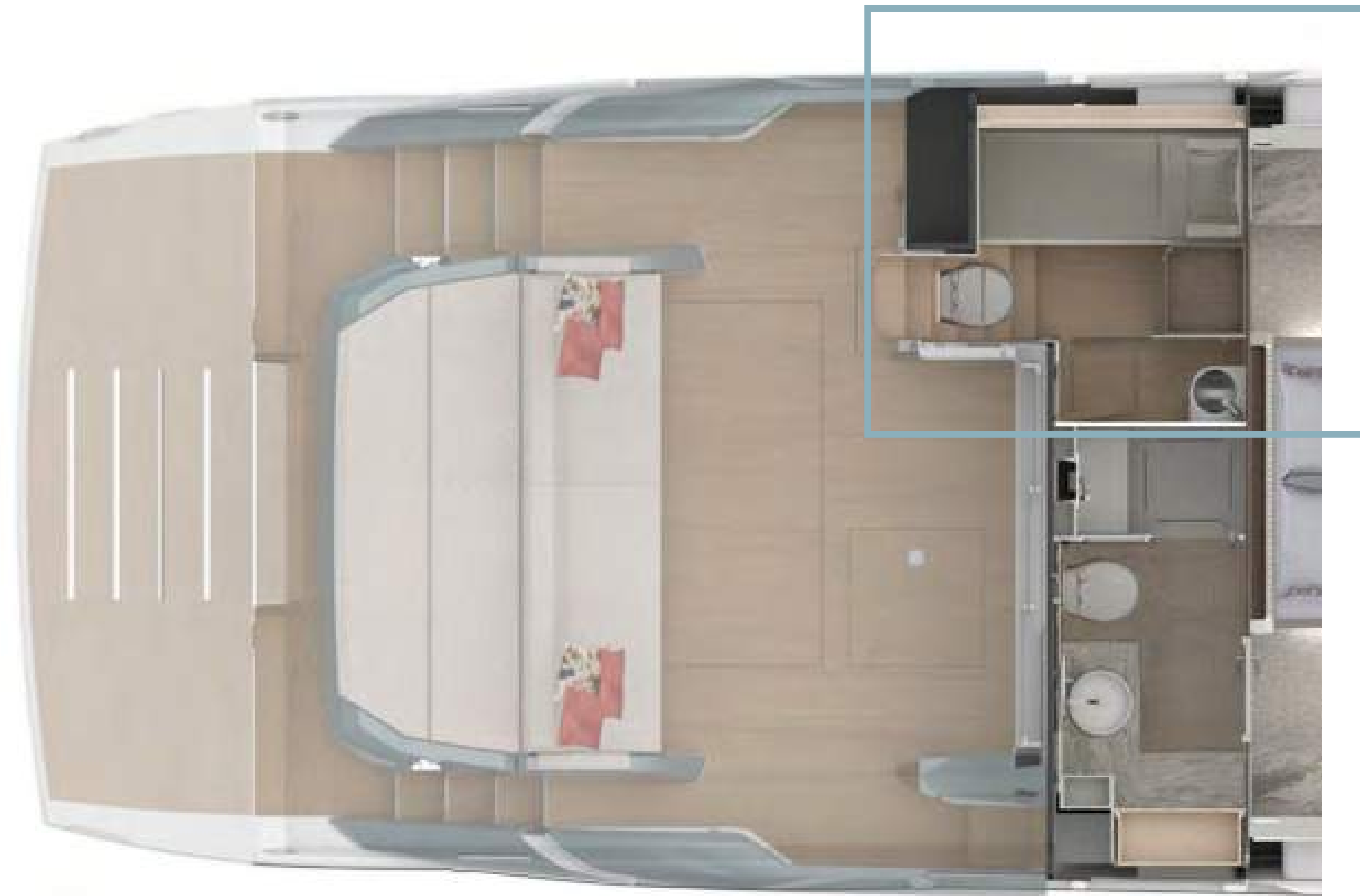

Outdoor Space

Developed in partnership with the Italian design studio CentroStile Design, the new Sessa F60 project also dedicated special attention to outdoor areas, ensuring more space for contact with nature.

There are four independent areas: the platform, aft cockpit, bow, and flybridge, offering various leisure and entertainment options.

Aft Platform

The aft platform features a fixed section and a submersible section with a hydraulic lift, making boarding easy and allowing it to be used as a private beach, providing added safety for enjoying the water.



Aft Square

On the transom, it is possible to request the installation of a unit with a gourmet area, offering an additional leisure option on board.



From the aft area, you can access the spacious garage, which has a hydraulic piston opening system and an electric winch, allowing for the storage of a jet ski or a tender of up to 2.80 meters, as well as extra space for accommodating water toys and diving equipment.

Aft and Cockpit

The aft cockpit is generously sized and provides excellent circulation. With a sofa and dining table, it integrates the environments, providing an excellent space for gatherings with family and friends.





Bow

At the bow, the highlight is the area featuring a large sunbed elevated above the deck level and a comfortable sofa strategically positioned into the windshield.

For those who want to experience the extraordinary, the bow area offers an incredible view and is an excellent space to relax in the fresh open air and enjoy the view.

Flybridge

Sessa Marine is known for emphasizing the flybridge in its yachts, and the F60 is no exception.

A spacious area accommodates the second helm station, surrounded by a comfortable sunbed, a gourmet cabinet, and an L-shaped sofa with a table, creating a beautiful terrace with a sea view to be enjoyed with the best company. For greater comfort and functionality, the area can be protected with a T-top cover.



Motorization and Technology

The propulsion system chosen to ensure the best performance and balance of the set is the 2x Volvo Penta IPS 950, with 725HP in each engine.

Whether relaxing outdoors or comfortably sheltered inside the vessel, the owner has access to a fully integrated monitoring system, with control over all essential and safety data, such as engine information, bilge pumps, power consumption and generation, alarms, and tank capacities.

Additionally, the system allows for the activation of onboard comfort controls, including lighting, air conditioning, and sound systems.





Beauty, attention to detail, usability, and cutting-edge technology are the characteristics that guide the design of this project, which combines the American style of sailing, emphasizing outdoor areas and performance, with the elegance and excellence of the finest Italian nautical style.

F60

Fly



F60

Main Deck



Lower Deck



Technical Specifications

TECHNICAL SPECIFICATIONS	
Total Length	18,30 m (60ft)
Mouth	4,98 m
Overall height (masthead span)	7,5 m
Draft	1,45 m
Passengers	14
Berth Passengers	6+1
Cabins	3+1
Engine	2x Volvo Penta IPS950 (D11-533kw/725HP)
Propulsion	IPS
Dry Displacement	27 t
Loaded Displacement	30 t
Fuel Tank	2.100 US gal
Water Tank	750 US gal
Waste Tank	160 US gal
Gray Water Tank	160 US gal

